

STORE MEZZANINE LEVEL  
PLAN @ LEVEL +39.725m

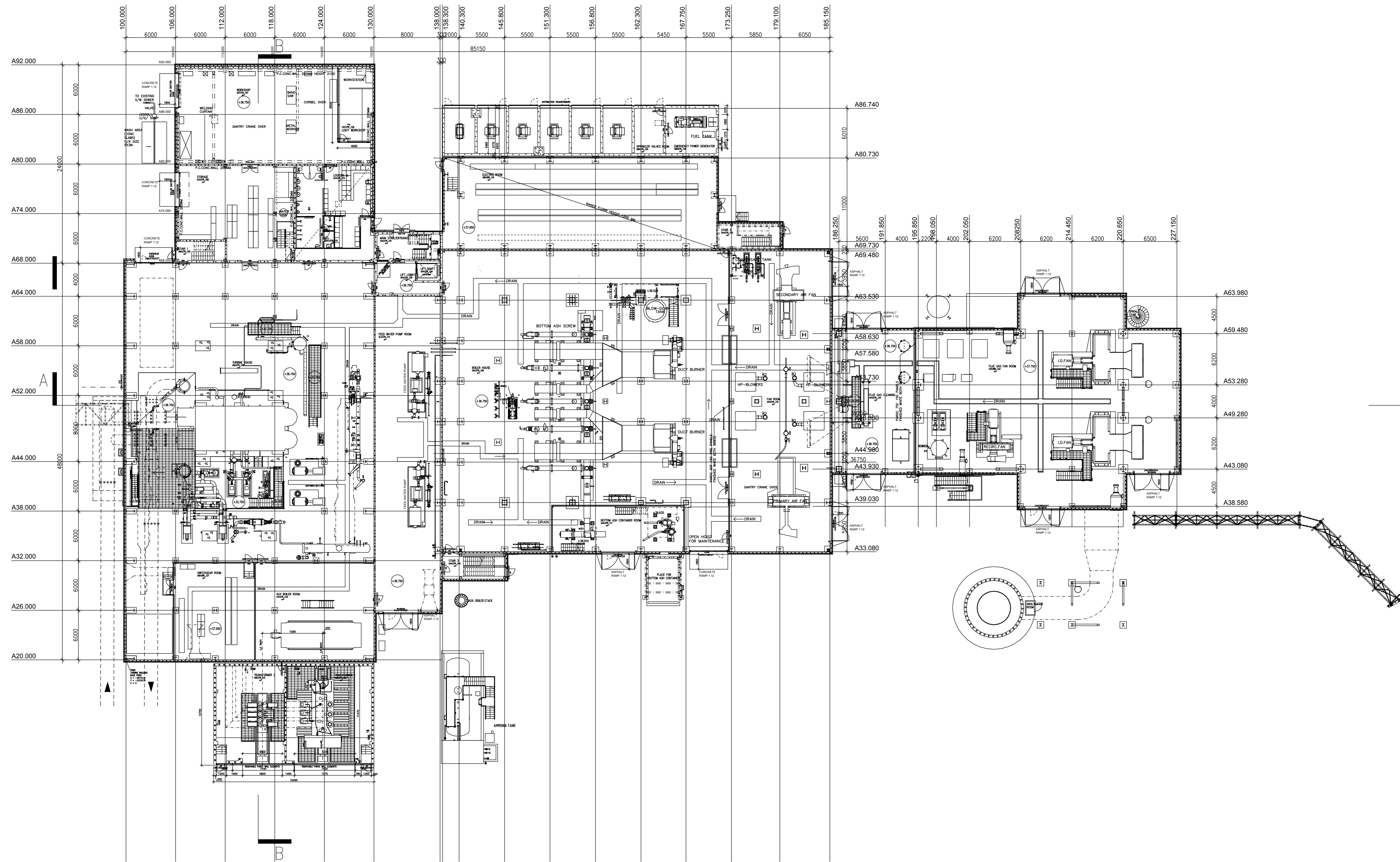

PLAN @ LEVEL +36.750m

NOTE:  
1. FOR SECTION A SEE DRG. QS-000206-01-D460-046  
2. FOR SECTION B SEE DRG. QS-000206-01-D460-046

NOTE:  
PLANS AND LAYOUT DRAWINGS SHOW PRINCIPLE FEATURES AND STRUCTURES OF THE SITE. AS WITH ALL INDUSTRIAL SITES, ON GOING OPERATIONS AND MAINTENANCE OCCASIONALLY NECESSITATE THE TEMPORARY USE OF MODULAR UNITS SUCH AS PORTACABINS FOR WELFARE FACILITIES, STORAGE ETC. THEIR USE IS TYPICALLY SHORT TERM, RELATED TO PARTICULAR ACTIVITIES AND DOES NOT CHANGE THE NATURE OR INTENSITY OF ACTIVITIES ON THE SITE.

KEY PLAN:

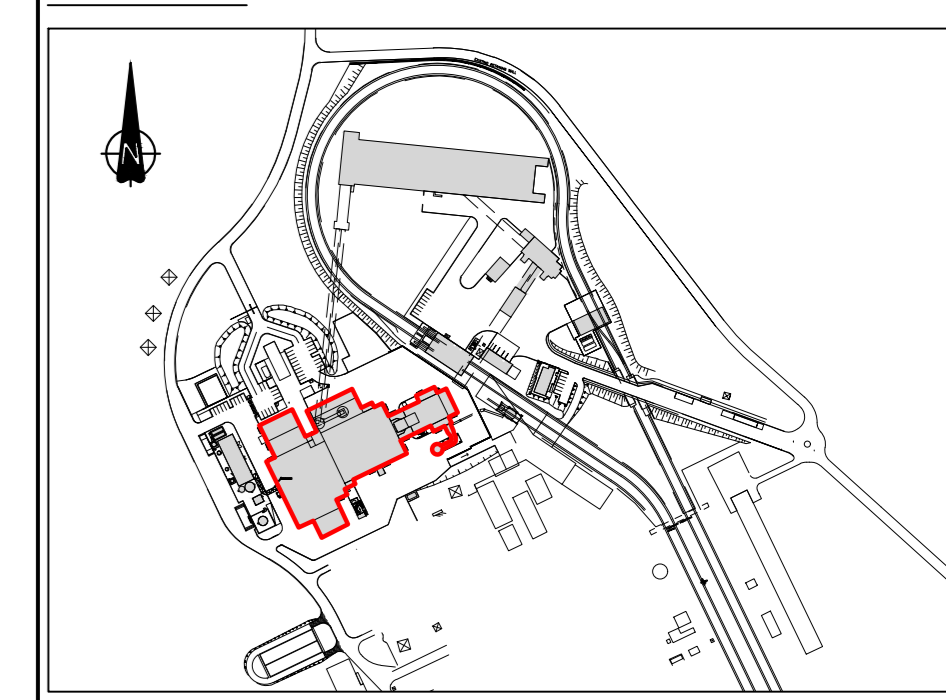

REV	DATE	DESCRIPTION	BY	CHK	PK	PN	BM
0	18.10.18	ISSUED FOR PLANNING	KMG	HCK	PK	PN	BM

Copyright © ESB International Limited  
All rights reserved. No part of this work may be reproduced, stored in a retrieval system, or transmitted in any form or by any means, electronic, mechanical, photocopying, recording, or by any information storage and retrieval system, without the written permission of ESB International Limited. Trading as ESB International.

PURPOSE OF ISSUE - PRELIMINARY (UNLESS INDICATED)  
CLIENT APPROVAL  PLANNING  TENDER  CONSTRUCTION  AS-BUILT

CLIENT: ESB

PROJECT: WEST OFFALY POWER TRANSITION TO BIOMASS

ENGINEER DESIGN: BORDCUMONA  
Naturally Driven  
Engineering Department  
Lansdown, Lansdowne, Co. Dublin, Tel: 0174345000

CONTRACT: WOP - TRANSITION TO BIOMASS

DRAWING TITLE: EXISTING MAIN POWER STATION BUILDING  
PLAN AT LEVEL +36.750m

PRODUCTION UNIT: CIVIL & ENVIRONMENTAL ENGINEERING

ESB INTERNATIONAL  
One Dublin Airport Central, Dublin Airport, Cloughran, Co. Dublin  
Tel: 903 1 703 8000 Email: marketing@esbi.ie  
Web: www.esbinternational.ie  
ESB International is a trading name of ESB Engineering & Facility Management Ltd  
Registered Office: as above. Registered in Ireland No. 115549

PRODUCED	VERIFIED	APPROVED	APPROVAL DATE
KMG	HCK	PK	18.10.18

CLIENT REF	NO. OF SHEETS	SIZE	SCALE
	1	A0	1:200

DRAWING NUMBER: QS-000206-01-D460-058  
SHEET: REV